

Raddrizzatore a Ponte Trifase Power Three Phase Bridge Rectifier

Serie MTS / Series MTS

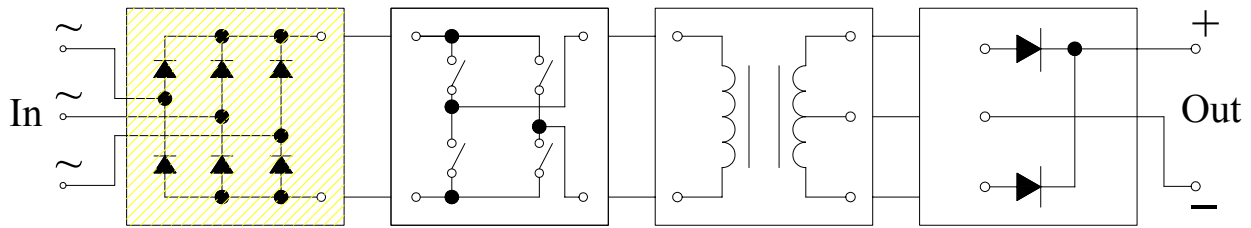

Tipo / Type	Iout	Vout(Max)	Vrrm	R _{Tj-c} Total	Vac isol t=60sec	IMS
	A	V	V	°C/W	V	mm
MTS 50.16/FF/FIX5	50	600	1600	0.6	2000	1.6
MTS 50.16/FS/FIX5	50	600	1600	0.6	2000	1.6
MTS 50.16/SF/FIX5	50	600	1600	0.6	2000	1.6
MTS 50.16/SS/FIX5	50	600	1600	0.6	2000	1.6
MTS 90.16/FF/FIX5	90	600	1600	0.523	2000	1.6
MTS 90.16/FS/FIX5	90	600	1600	0.523	2000	1.6
MTS 90.16/SF/FIX5	90	600	1600	0.523	2000	1.6
MTS 90.16/SS/FIX5	90	600	1600	0.523	2000	1.6

FF: In=Faston Out=Faston	FS: In=Faston Out= Screw(M5)	SF: In=Screw(M5) Out=Faston	SS: In=Screw(M5) Out=Screw(M5)	FIX5: Hole for Srew M5
---------------------------------------	---	--	---	----------------------------------

MTS 50.16 SS FIX5

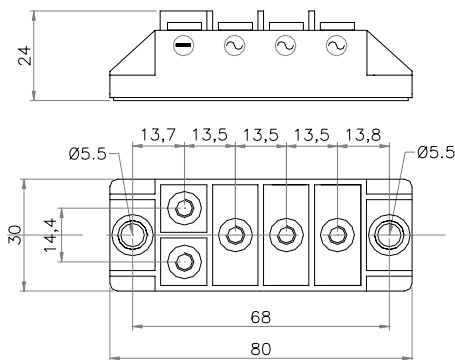

MTS 90.16 SS FIX5

