

## Serie/Series:SCOMES

### Applicazioni / Applications

- Usati per saldatrici, caricabatterie, inverters, moduli fotovoltaici, convertitori, raddrizzatori per galvanica.
- For welding machines, battery chargers, inverters, photovoltaic modules, converters, galvanic rectifier.

Corrente Current	Caduta di Tensione Drop Voltage	Codice Code
50A	100mV	009000040000

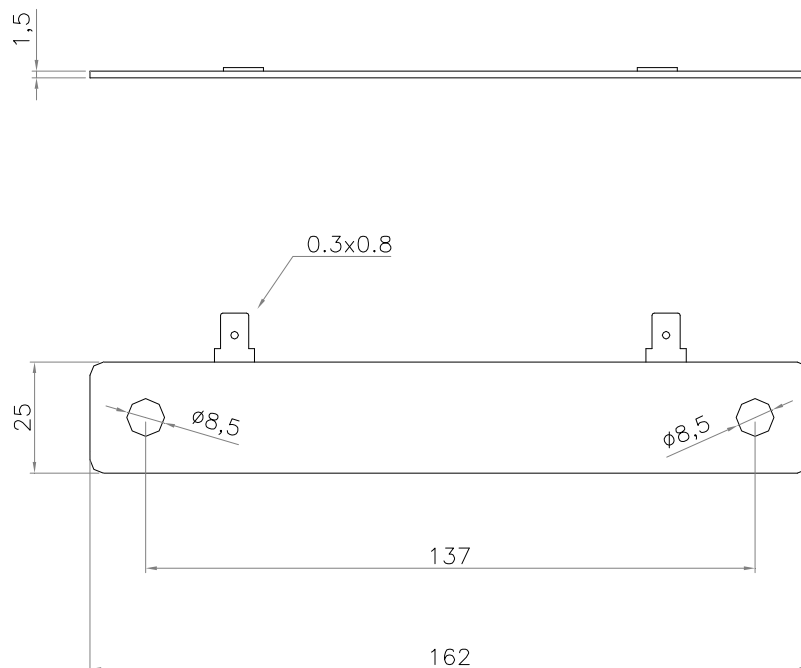

# Shunt Scomes

Corrente Current	Caduta di Tensione Drop Voltage	Codice Code
50A	100mV	009000040001

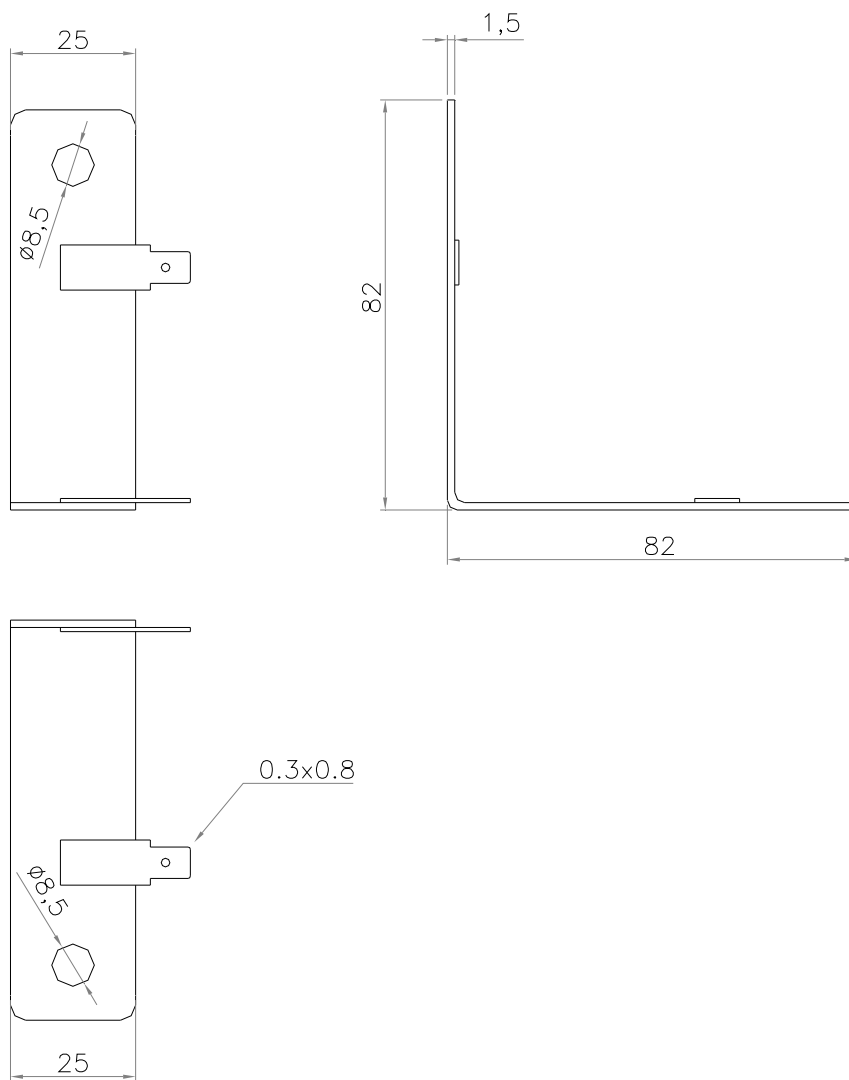

## Shunt Scomes

Corrente Current	Caduta di Tensione Drop Voltage	Codice Code
100A	100mV	009000090000

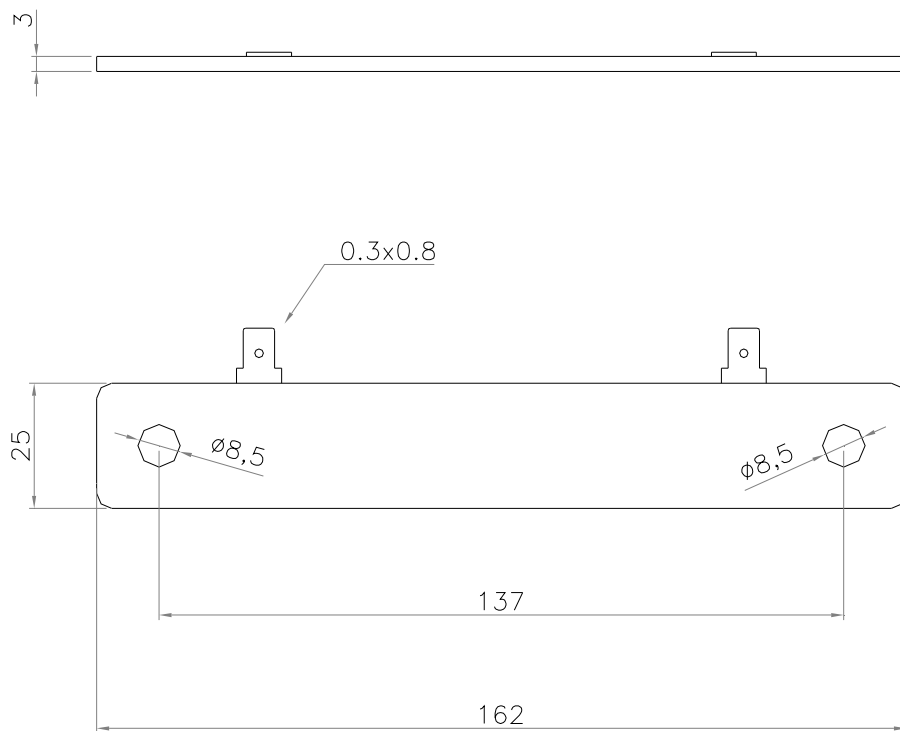

# Shunt Scomes

Corrente Current	Caduta di Tensione Drop Voltage	Codice Code
100A	100mV	009000090002

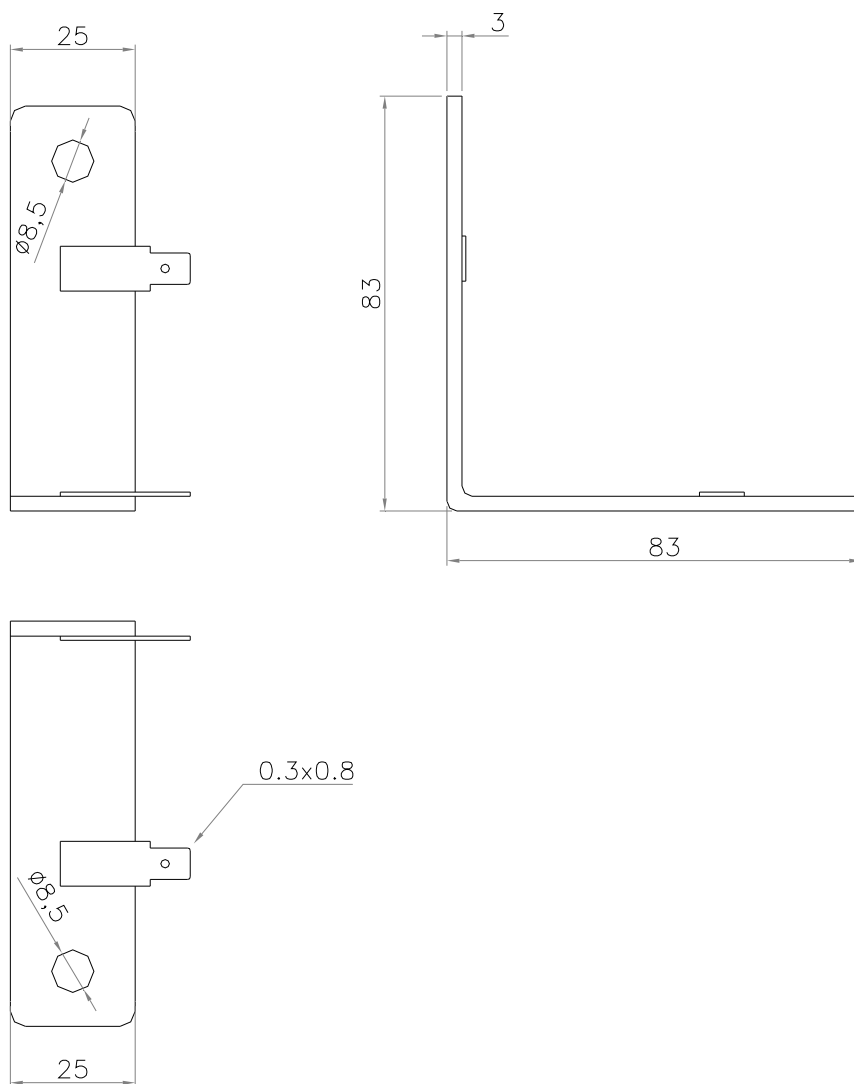

## Shunt Scomes

Corrente Current	Caduta di Tensione Drop Voltage	Codice Code
200A	100mV	009000090001

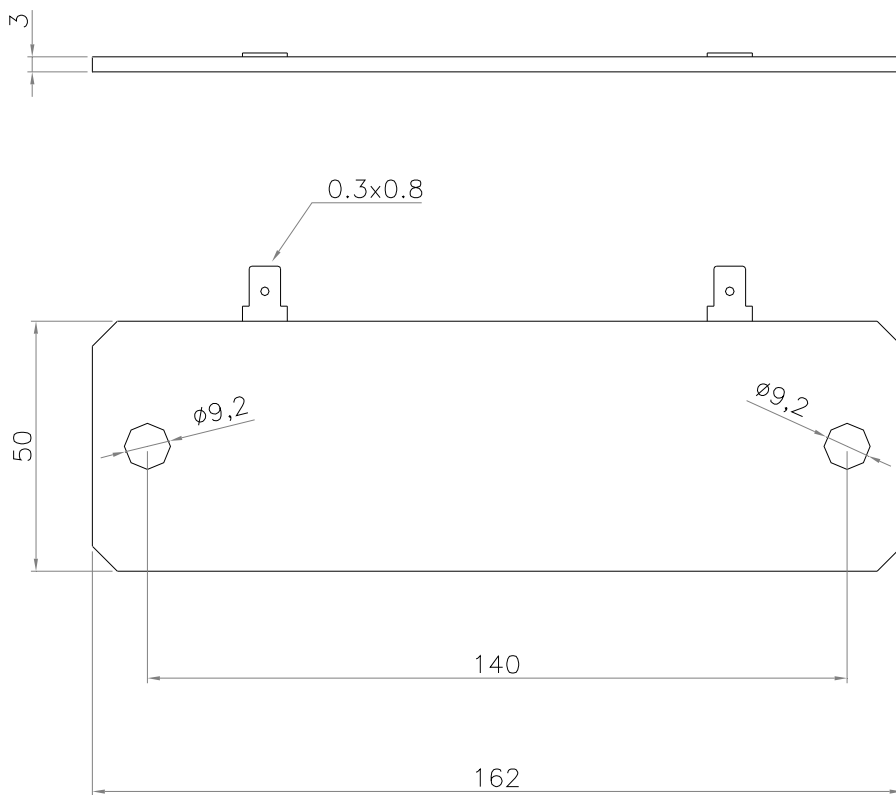

## Shunt Scomes

Corrente Current	Caduta di Tensione Drop Voltage	Codice Code
200A	100mV	009000040003
<p>Technical drawing of a shunt resistor showing three views: top, side, and bottom. The top view shows a rectangular component with a width of 50 and a central circular feature with a diameter of 9.2. The side view shows a height of 83 and a thickness of 3. The bottom view shows a width of 50 and a central circular feature with a diameter of 9.2, and a small rectangular feature with dimensions 0.3x0.8.</p>		